



**YSPM's**  
**Yashoda College of Architecture**

**Index- 7.1.3**

7.1.3	Quality audits on environment and energy regularly undertaken by the Institution. The institutional environment and energy initiatives are confirmed through the following 1.Green audit / Environment audit 2.Energy audit 3.Clean and green campus initiatives 4.Beyond the campus environmental promotion activities	
Sr. No	Particulars	Page no.
1	Policy document on Environment and Energy usage.	1 To 2
2	Action taken reports as clear and green campus	3 To 8



*D. A. K. ors*

**Principal**  
Yashoda College of Architecture  
Satara

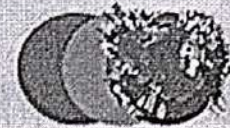

# Policy Document

## Environment and Energy usage Certificate

### Introduction:

Our auditing agency recognizes the importance of environmental sustainability and energy conservation. We believe that it is our responsibility to actively promote sustainable practices among our clients and stakeholders. As part of our commitment to environmental protection and energy efficiency, we have developed a policy for Environment and Energy Usage Certificate.

### Policy Statement:

Our auditing agency is committed to reducing Environmental Impact and promoting Energy Efficiency. We aim to achieve this by conducting Audits that assess the Environmental performance and Energy usage of our clients. The purpose of these Audits is to help clients identify areas where they can improve their Environmental Sustainability and Energy Efficiency, and to develop strategies to reduce their Carbon footprint.

### Objectives:

Our objectives for Environment and Energy Usage Certificate are as follows:

1. To promote Environmental Sustainability and Energy Efficiency among our clients.
2. To help our clients reduce their Carbon footprint and mitigate their impact on the Environment.
3. To comply with relevant Environmental Legislation and Regulations.
4. To promote Energy-efficient technologies and practices.
5. To develop and implement Sustainable strategies for our own operations.

### Scope:

This policy applies to all audits conducted by our agency, where Environmental Sustainability and Energy Efficiency are relevant factors.

### Procedure:

Our agency follows the following procedures to implement the Environment and Energy Usage Certificate policy:



1. We conduct an audit of the client's operations, including their Energy usage and Environmental impact.
2. We provide the client with a detailed Report that identifies areas where they can improve their Environmental Sustainability and Energy Efficiency.
3. We provide Recommendations for strategies and technologies that the client can implement to reduce their Carbon footprint and improve Energy Efficiency.
4. We issue an Environment and Energy Audit Certificate to the client, which acknowledges their efforts to improve their environmental performance and energy efficiency.

**Resources:**

Our agency requires the following resources to implement the Environment and Energy Usage Certificate policy:

1. Trained auditors with knowledge of Environmental Sustainability and Energy Efficiency.
2. Access to relevant Environmental Legislation and Regulations.
3. Access to information on Energy-Efficient technologies and practices.

**Responsibilities:**

All employees of our agency are responsible for ensuring compliance with this policy. Specific responsibilities are as follows:

1. Auditors will ensure that all audits are conducted in accordance with this policy.
2. The management team will provide the necessary resources and support for the implementation of this policy.
3. The quality assurance team will ensure that all audits comply with this policy.

**Conclusion:**

Our agency is committed to promoting Environmental Sustainability and Energy Efficiency through our Environment and Energy Audit Certificate policy. We believe that by encouraging our clients to reduce their Carbon footprint and adopt Sustainable practices, we can contribute to a more Sustainable future.





**YSPM's  
Yashoda College of Architecture**

A REPORT ON

**ACTION TAKEN REPORT AND ACHIEVEMENT REPORT AS  
CLEAN AND GREEN CAMPUS INITIATIVE**

**1. Energy Conservation:**

Installed energy-efficient appliances and lighting fixtures throughout the campus.  
Conducted awareness drives and workshops on energy conservation for students and staff.  
Promoted the use of natural lighting and ventilation in buildings.  
Annually audited energy consumption to identify areas for improvement.

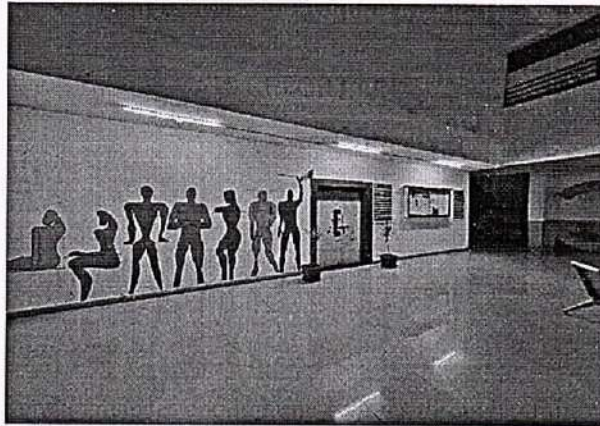

Energy Efficient Lighting Appliance (LED) are Provide in building





**YSPM's**  
**Yashoda College of Architecture**

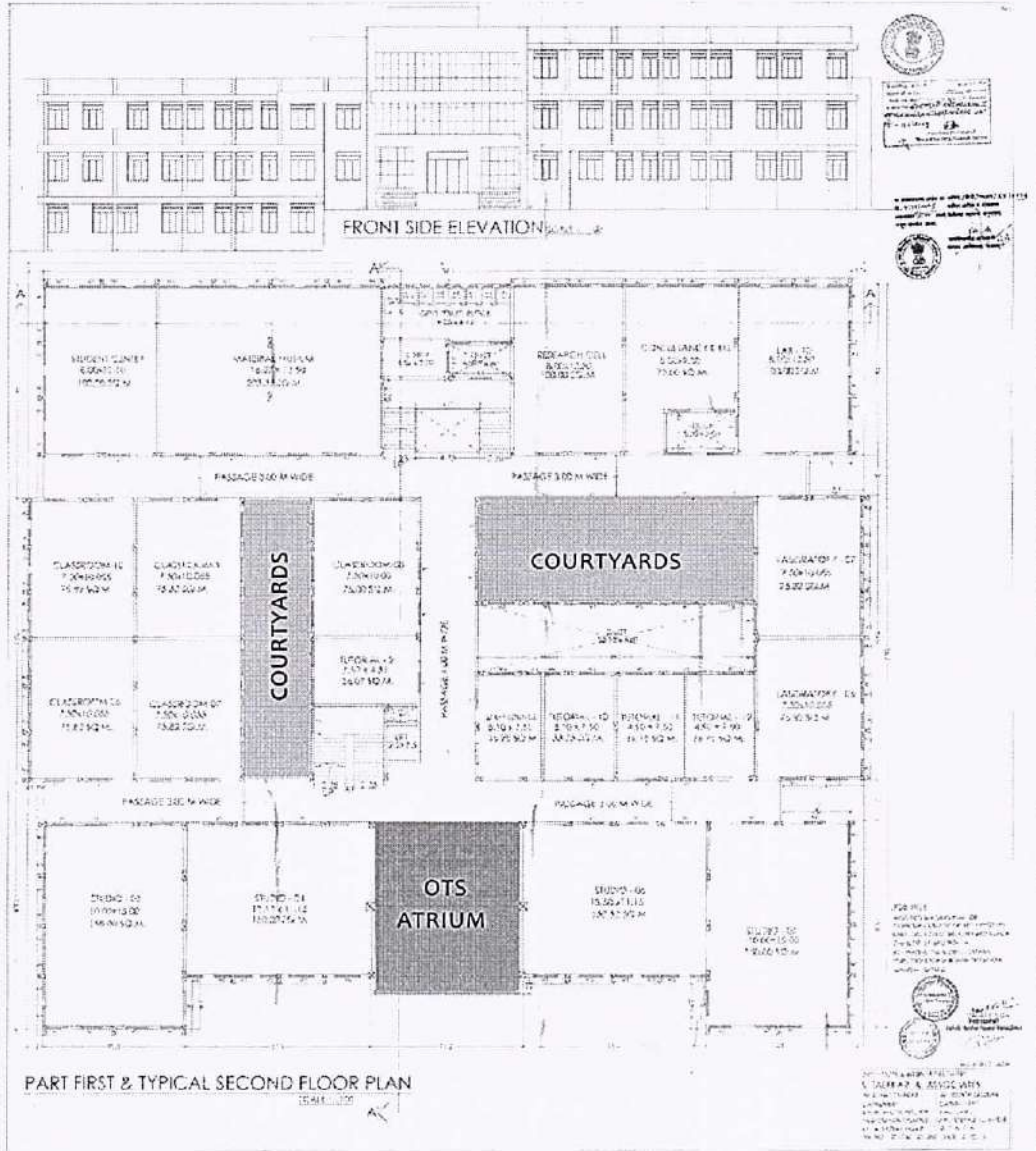

Building has been Designed by Considering natural light and natural ventilations





## 2. Waste Reduction:

Implemented a comprehensive waste management system, including separate bins for recycling and composting.

Conducted campaigns and workshops to raise awareness about waste reduction and recycling.

Collaborated with RIDOFT agency for waste collection and recycling.

Encouraged students, faculty, and staff to use refillable water bottles and reduce paper usage.

Introduced a mandatory collection of a minimum amount of plastic waste from students to promote recycling.



Waste management & reduction with the help of Dustbin.





### 3. Water Conservation:

Raised awareness about water conservation, leading to behavioural changes among students and staff.

**Sprinkler System for Landscape:** To ensure efficient water usage in the campus landscape, Yashoda College of Architecture installed a modern and water-efficient sprinkler system. The sprinkler system is designed to deliver water precisely to the targeted areas, minimizing water wastage. This system allows for the optimal growth and maintenance of the campus landscape while conserving water resources and promoting sustainability.

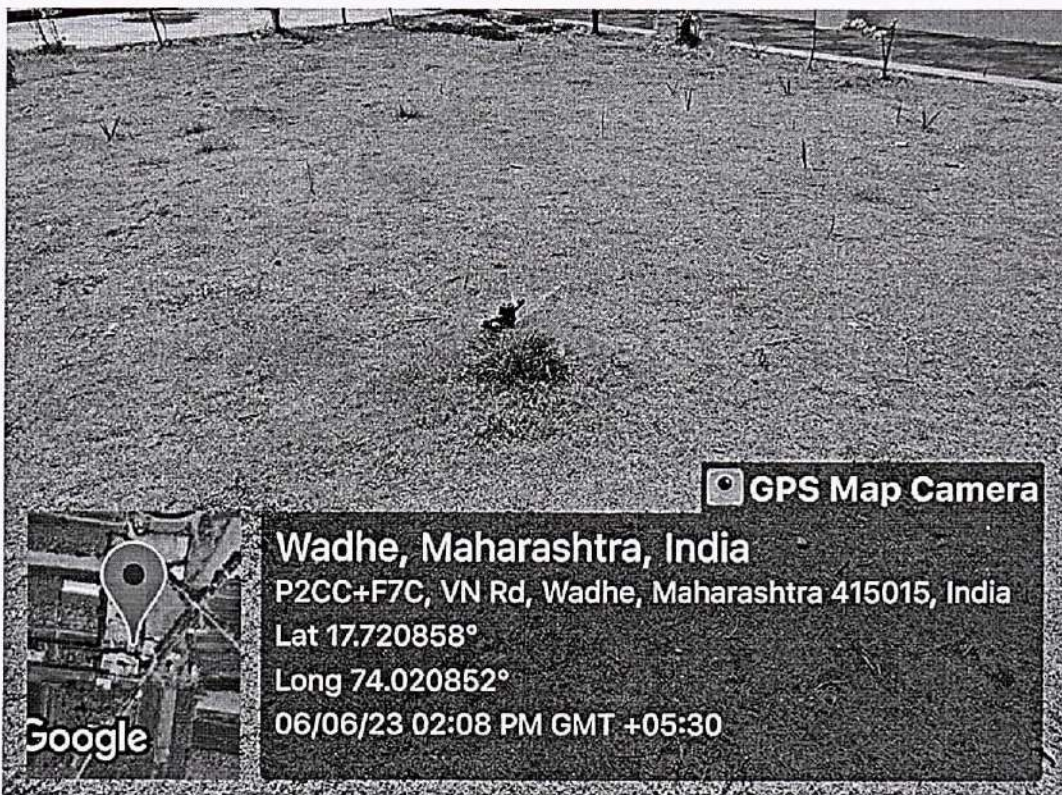

Sprinklers are provided within whole campus for minimum water consumption & conservation





**YSPM's  
Yashoda College of Architecture**

---

**4.Tree Plantation:**

Arranged tree plantation drive within the campus, contributing to improved aesthetics and enhanced biodiversity.

Created green spaces that provide shade and contribute to the overall well-being of the campus community.



Every year we arrange tree plantation drive to enhance bio-diversity & aesthetics.

*Signature*







## **YSPM's Yashoda College of Architecture**

---

### **5. Education and Awareness:**

Increased sustainability literacy among students, faculty, and staff through courses, workshops, and seminars.

Generated awareness about the importance of recycling and waste reduction through student exhibitions and campaigns.

Created a culture of sustainability on campus, with students actively incorporating sustainable design practices in their architectural projects.

### **7. Posters with Slogans to Save Water and Electricity:**

The implementation of posters with slogans to save water and electricity across the campus, including classrooms, studios, and staffrooms, aimed to raise awareness and promote sensitivity towards resource conservation.

The presence of posters in classrooms, studios, and staffrooms prompted individuals to reflect on their resource usage habits.

Behaviour changes included turning off lights when not in use, conserving water during daily activities, and being mindful of energy usage.

The posters sparked conversations and discussions among the campus community.

Students, faculty, and staff engaged in dialogues about sustainable practices, sharing tips and ideas to further conserve resources.

The posters served as conversation starters, fostering a sense of community and collective responsibility towards sustainability.

Overall, the collective efforts of Yashoda College of Architecture in implementing these Green Policies and Initiatives have resulted in tangible Achievements. These include significant reductions in Energy and Water consumption, increased recycling rates, sustainable construction practices, and the promotion of a culture of sustainability among students and staff.

By continuously evaluating and updating their policies and practices, Yashoda College of Architecture is poised to further enhance its Clean and Green Campus Initiatives, ensuring a Sustainable and Environmentally friendly learning and living environment for all.



*Dalekar*